

ALLDAY
& MILLER



Hayes End Road, Hayes, UB4 8EJ
£2,500





Hayes End Road, Hayes, UB4 8EJ

£2,500

- Four Bedrooms
- Large South Facing Garden
- Easy Access To Uxbridge Road
- Newly Fitted Kitchen
- Semi-Detached Family Home
- Walking Distance To Shops
- Fourth Bedroom Located on the Ground Floor
- Hillingdon Council (Tax Band D)

Description

This versatile family home comprises of a welcoming entrance hall, light filled reception room, dining room/ currently being used as a ground floor bedroom, fully fitted kitchen and a family room which overlooks and provides access to the rear garden.

The first floor enjoys three bedrooms (two with fitted wardrobes) and a family bathroom.

A low maintenance front garden leads you to the front door. To the rear enjoys a large south facing private garden, mainly laid to lawn.

Situation

Hayes End Road situated in an extremely sought after residential area within walking distance of all local amenities including Mellow Lane School, bus routes, shops, and parks. There is also ease of access to transport links and fantastic motorway connections with the M40 / M25 / M4 all within close proximity of the property. Hayes and Harlington Station is also nearby which provides access to the Elizabeth line making the journey into central London a breeze.



Floor Plans

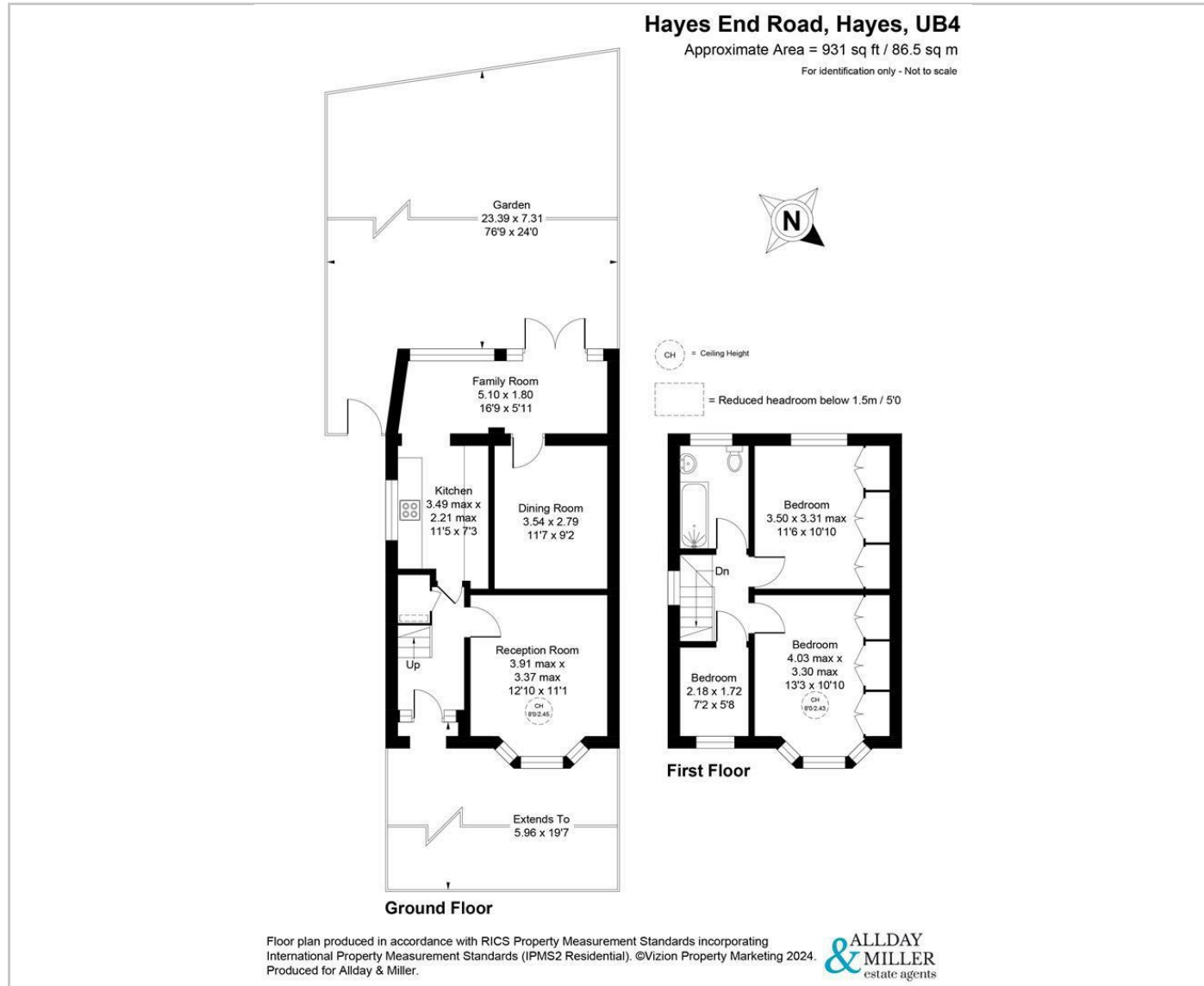

Area Map

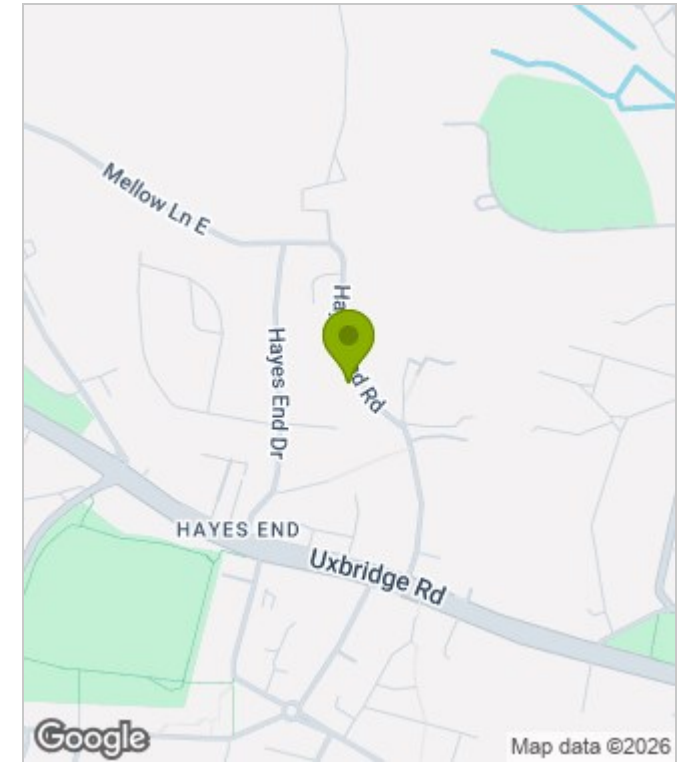

Energy Performance Graph

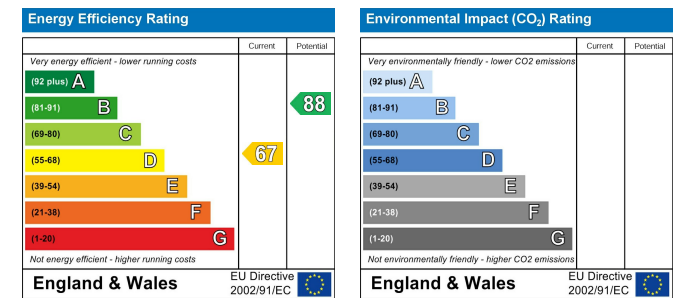

These particulars, whilst believed to be accurate are set out as a general outline only for guidance and do not constitute any part of an offer or contract. Intending purchasers should not rely on them as statements of representation of fact, but must satisfy themselves by inspection or otherwise as to their accuracy. No person in this firm's employment has the authority to make or give any representation or warranty in respect of the property.

www.alldayandmiller.co.uk

192 High Street, Uxbridge, Middlesex, UB8 1LB

T: 01895 641 000 | E: sales@alldayandmiller.co.uk

T: 01895 379 549 | E: lettings@alldayandmiller.co.uk